

W:\2023 Projects\2023010 Highland Reserve\WORKING CAD\C4-PRELIM-UTILITY PLAN-F23010.dwg Aug 28, 2023 - 02:50 pm

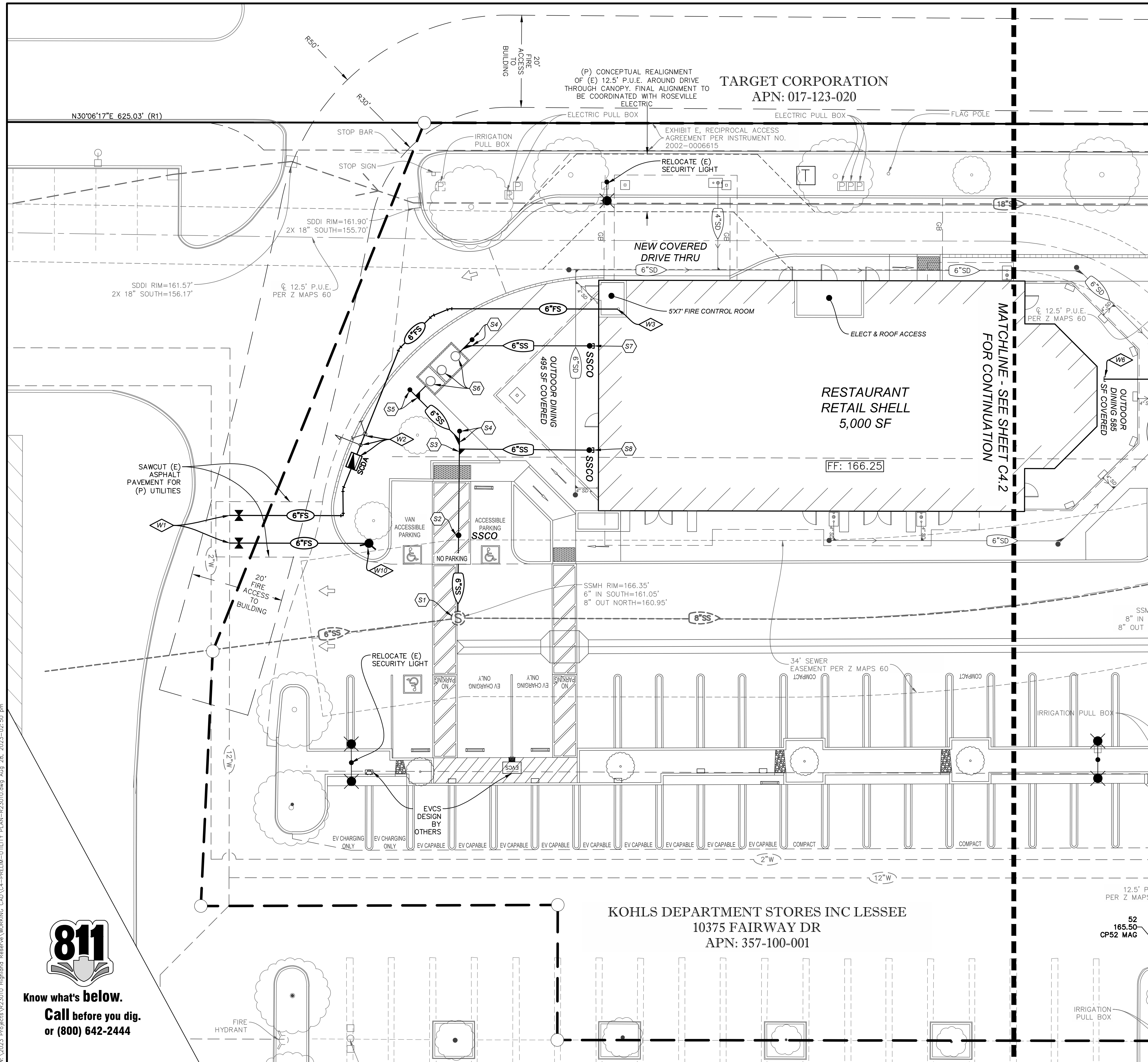

**Know what's below.**  
**Call before you dig.**  
 or (800) 642-2444



### LEGEND

DESCRIPTION	EXISTING	PROPOSED
SANITARY SEWER	XX"SS	XX"SS
WATER	XX"W	XX"W
FIRE SERVICE	XX"FS	XX"FS
STORM DRAIN	XX"SD	XX"SD
SSMH	SSMH	SSMH
SSCO	SSCO	SSCO
FIRE HYDRANT	FIRE HYDRANT	FIRE HYDRANT
P.V.	P.V.	P.V.
FDC	FDC	FDC
WATER VALVE	WM	WM
WATER METER	WM	WM
REDUCED PRESSURE BACKFLOW PREVENTER	RP	RP
STREET LIGHT	SL	SL

90° TEE 45° 22.5° 11.25°

- #### SANITARY SEWER CONSTRUCTION KEYNOTES:
- S1 CONNECT (P) 6" COMMERCIAL SEWER LATERAL TO (E) SEWER MANHOLE PER PLAN.
  - S2 CLEANOUT TO GRADE JUST OUTSIDE SEWER EASEMENT.
  - S3 COMBINATION WYE & 1/2 BEND.
  - S4 COMBINATION WYE WITH OFFSET CLEANOUT TO GRADE.
  - S5 COMBINATION WYE & 1/2 BEND WITH OFFSET CLEANOUT TO GRADE.
  - S6 GREASE INTERCEPTOR.
  - S7 GREASE INTERCEPTOR POINT OF CONNECTION TO BUILDING.
  - S8 SANITARY SEWER POINT OF CONNECTION TO BUILDING.

- #### WATER CONSTRUCTION KEYNOTES:
- W1 12"x12"x6" REDUCING TEE.
  - W2 SINGLE CHECK VALVE ASSEMBLY VAULT, P.V. AND FIRE DEPARTMENT CONNECTION.
  - W3 6" FIRE SPRINKLER SERVICE POINT OF CONNECTION TO BUILDING.
  - W4 1.5" COMMERCIAL WATER SERVICE AND METER.
  - W5 1.5" REDUCED PRESSURE BACKFLOW PREVENTER.
  - W6 1.5" COMMERCIAL WATER SERVICE POINT OF CONNECTION TO BUILDING.
  - W7 3/4" COMMERCIAL IRRIGATION WATER SERVICE.
  - W8 3/4" IRRIGATION REDUCED PRESSURE BACKFLOW PREVENTER.
  - W9 3/4" IRRIGATION POINT OF CONNECTION.
  - W10 6" FIRE HYDRANT ASSEMBLY.
  - W11 WATER SERVICE GATE VALVE.
  - W12 CONNECT TO EXISTING ON-SITE MAIN.
- WATER NOTES:  
 1.) WATER PIPE SIZES 4" - 12" SHALL BE C-900 PVC.  
 2.) WATER PIPE SIZES <4" SHALL BE SCHEDULE 80 PVC.

10 0 10 20

1 INCH = 10 FEET

Sheet  
**C4.1**  
 6 of 8  
 08/18/2023

APPROVED BY: [Signature]

DATE: [Date]

REVISION: [Table]

BY: [Name] CHECK: [Name] TSM: [Name]

DESIGN: [Name] DRAWN: [Name] QUANT.: [Name]

ORIGINAL SCALE IS 1/4" = 1' INCHES

NOT FOR CONSTRUCTION

**GSB ARCHITECTURE, INC.**  
 8502 LILLIPUT WAY  
 EL DORADO HILLS, CA 95762  
 CONTACT: GREG BALDERREE  
 PH: (916) 933-8033

**CWE**  
 2288 Peachtree Industrial Blvd., Suite 100, Peachtree City, GA 30661  
 PH: (770) 772-7800 | WWW.CWEENGINEERING.COM

HIGHLAND RESERVE  
 EXISTING: 10375 FAIRWAY DRIVE  
 PROPOSED: 10385 FAIRWAY DRIVE  
 ROSEVILLE, CA 95678  
**PRELIMINARY WATER & SANITARY SEWER PLAN 1**

CWE PROJECT R23010 - HIGHLAND RESERVE - ROSEVILLE, CA

